

RAMFAN 40V EX50Li G3 BrushlessPPV

RAMFAN[®]

Superior Upgrade Designed Exclusively for Firefighting

Product Overview

The RAMFAN 40V EX50Li G3 (EL5900) provides the highest power available for firefighters with upgrades that includes an increased power of 67% higher than the Gen 2 EX50Li, a new OLED digital display on the controller, optional MagCode power port and optional AT frame configuration.

The RAMFAN 40V EX50Li G3 offers flexible charging options designed for fire apparatus readiness. With their on-tool charging, it supports AC charging from standard wall power, allowing the fan to run continuously without draining the batteries while initiating charging of the installed packs when the fan is not running.

The G3 also supports DC charging via our new MagCode Rapid Charger, featuring a magnetically guided DC plug that enables fast, glove-friendly connections with built-in breakaway safety inside the apparatus. For added flexibility, the external Dual-Pack Rapid Charger allows simultaneous charging of two battery packs outside the fan—ensuring fully charged spares are always ready when you need them.

Key Features

- **User Interface:** OLED digital display with runtime, speed settings, modes, and messages
- **Wireless Connectivity:** Pro//Connect allows remote operations and diagnostics.
- **Safety Features:**
 - ROPS: Faster response for enhanced safety during critical movements.
 - LED Flood Lights: Low runtime warning with integrated shroud flash signaling.
- **DC Charging:**
 - MagCode Rapid Charger provides a safe, self-aligning DC connection with its magnetic design.
- **AC Charging:**
 - When plugged in, the internal power supply will provide unlimited AC time.
 - While connected, the system can charge the 40V battery packs mounted on the fan.

Unmatched 1kW motor performance for superior ventilation.

The RAMFAN EX50Li G3 Brushless PPV (EL5900) provides a highly efficient and adaptable solution for firefighters. Now available with rugged all-terrain wheels!



www.frsa.com.au | admin@frsa.com.au | + 61 7 3209 7422

RAMFAN 40V EX50Li G3 BrushlessPPV

Superior Upgrade Designed Exclusively for Firefighting

RAMFAN[®]

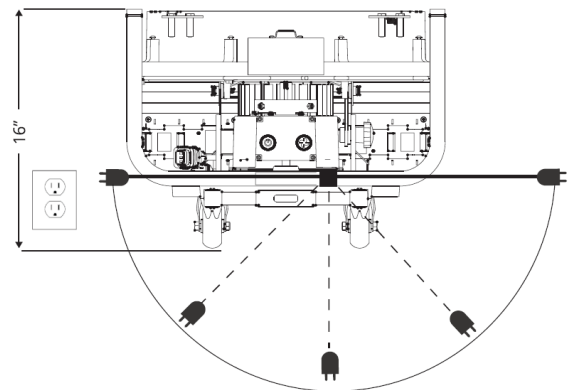
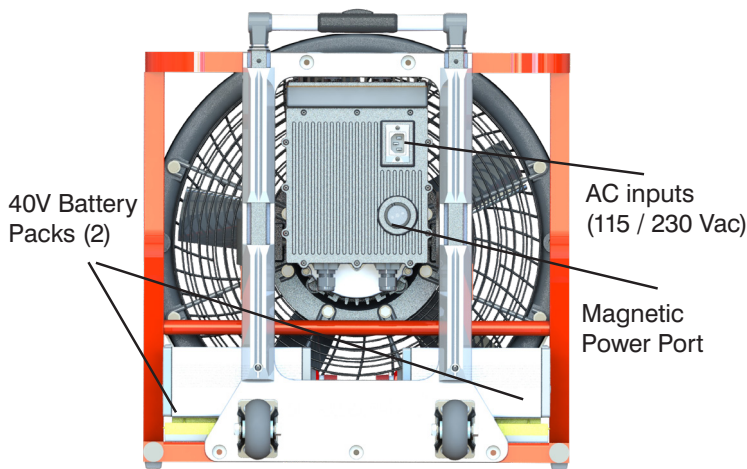

10" AC outlet placement for on-tool charging



TRUCKFIT

FAN	SIZE		DIMENSIONS (HxLxD)	
	in	cm	in	cm
40V	18	46	22 x 21 x 16	56 x 53 x 41

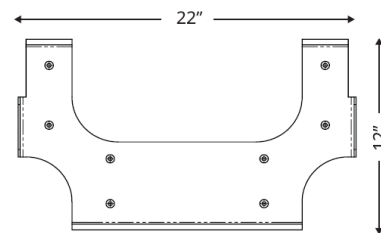

Vehicle Mount

67% higher power than the Gen 2 EX50Li with a better runtime (1kW continuous / 1.4kW MAX mode™)

Integrated OLED digital display with runtime, speed settings, modes, and messages.



Flexible charging options with the On-Tool AC, MagCode Rapid, and Dual-Pack Rapid Chargers.

Available in standard frame with optional AT frame configuration.



www.frsa.com.au | admin@frsa.com.au | + 61 7 3209 7422

RAMFAN 40V EX50Li G3 BrushlessPPV

RAMFAN®

Superior Upgrade Designed Exclusively for Firefighting

Technical Specifications

Model Number	PRO//Connect	Makita	
115V Urban Edition 115V All-Terrain Edition 230V Urban Edition 230V All-Terrain Edition	EL5900 EL5925 EL5900-E EL5925-E		
Motor	1kW Brushless PPV		
Runtime @ Max. Speed	45 min - 40v/10Ah (Part# M5-40V) AC: Unlimited		
Input Voltage Ranger	Universal Input: 113-230V _{AC} 1Ø, 50/60 Hz		
Consumption (Running @ 100%, AC)	700 W		
Consumption (During On-Tool Charging)	168W	N/A	
Charger Output	4A / 2A per battery (simultaneous)	N/A	
MagCode Rapid Charger	Optional	N/A	
Dual-Pack Rapid Charger	Optional	N/A	
Battery System Performance (M5-40V)	See Makita specification		
Nominal Energy			720 Wh
Maximum Discharge Current			20 A
Cycle Life DoD 80%			>500 Cycles (at 1C charge/ discharge 100% DoD)
IP Rating			IP66
Wireless Diagnostics			via NFC/BLE to PRO//connect mobile app
Recycling Mode			Safety Recycle by draining residual energy
Maintenance Mode	Initial Cell Balancing in low use fans		
Dimensions	22 x 21 x 16 in/56 x 53 x 41cm 22 x 21 x 12 in/56 x 53 x 30cm (AT frame) (wheel kit removed)		
Weight	54 lbs / 25 kg		
Noise	<90 dB		
Operating Temp Range	-4°F to 105°F / -20°C to 40°C		
Charge Temp Range	-32°F to 105°F / -0°C to 40°C		
Tilt	-10° to +34°		
Conforms to	CE * N		
Airflow: AMCA 240-22 pending			

www.frsa.com.au | admin@frsa.com.au | + 61 7 3209 7422